

interatletikaTM

PRODUCTION AND SALE OF SPORTS GOODS

Customer support:

+38 095 273 81 53

play.interatletika.com

DATA SHEET

Gymnastic complex S832.6

The product meets EN16630-2015 requirements.

CONTENT

1. GENERAL INFORMATION	3
2. BASIC TECHNICAL DATA AND CHARACTERISTICS.....	3
3. COMPONENTS AND CHARACTERISTICS OF THE MAIN PARTS OF THE PRODUCT	5
4. PRODUCT ASSEMBLY AND INSTALLATION PROCEDURE	5
5. PRODUCT INSTALLATION SCHEME.....	9
6. INFORMATION ON STORAGE, TRANSPORT AND DISPOSAL	10
7. USE OF THE PRODUCT	10
8. PRODUCT MAINTENANCE	10
Apendix A	13

1. GENERAL INFORMATION

Producer "Company Sporttehnika" LLC, Ushinsky str. 24, Chernigov, Ukraine.

Purpose and content of this document. This document contains a general description, installation information, use of the product as intended, maintenance, routine repairs, and manufacturer's guarantees.

Distribution of this document for product modifications. The manufacturer can make changes to the design of the product aimed at improving its characteristics, changing the design, etc. This document may not contain a description of such changes, but it applies to such modified products.

2. BASIC TECHNICAL DATA AND CHARACTERISTICS

№	Product code	Name	Dimensions			Weight, kg	Fall height, mm
			Length, mm	Width, mm	Height ¹ , mm		
1	S832.6	Horizontal bar 2-level	3330	173	2705	95	1500
Age restrictions, years			from 12				
Weight restrictions, kg			up to 130				

1. The height of the point above ground (cover).

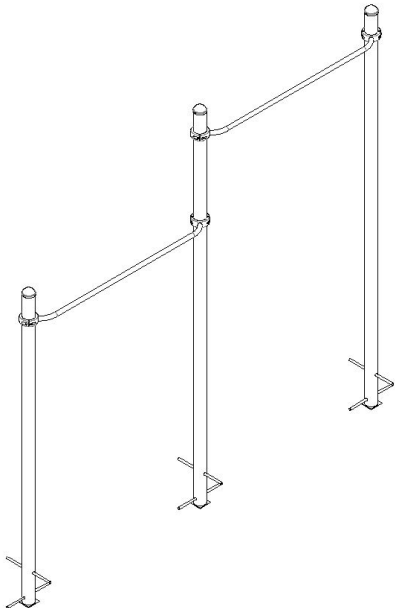
Horizontal bar 2-level	S832.6
	

3. COMPONENTS AND CHARACTERISTICS OF THE MAIN PARTS OF THE PRODUCT

See Appendix A for the complete set and characteristics of the component parts of the product.

4. PRODUCT ASSEMBLY AND INSTALLATION PROCEDURE

Tools and accessories. The product kit does not include the tools necessary for its assembly and installation.

The order of assembly and installation of the product.

1. Assemble the racks together according to the drawing, if the design requires it (see the appendix).

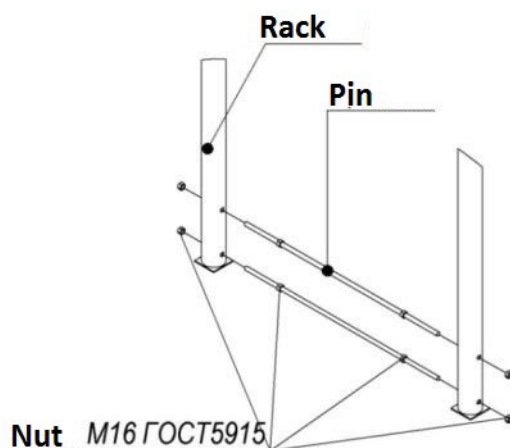

2. Assemble the bench according to the drawing, if the design requires it (see the appendix).

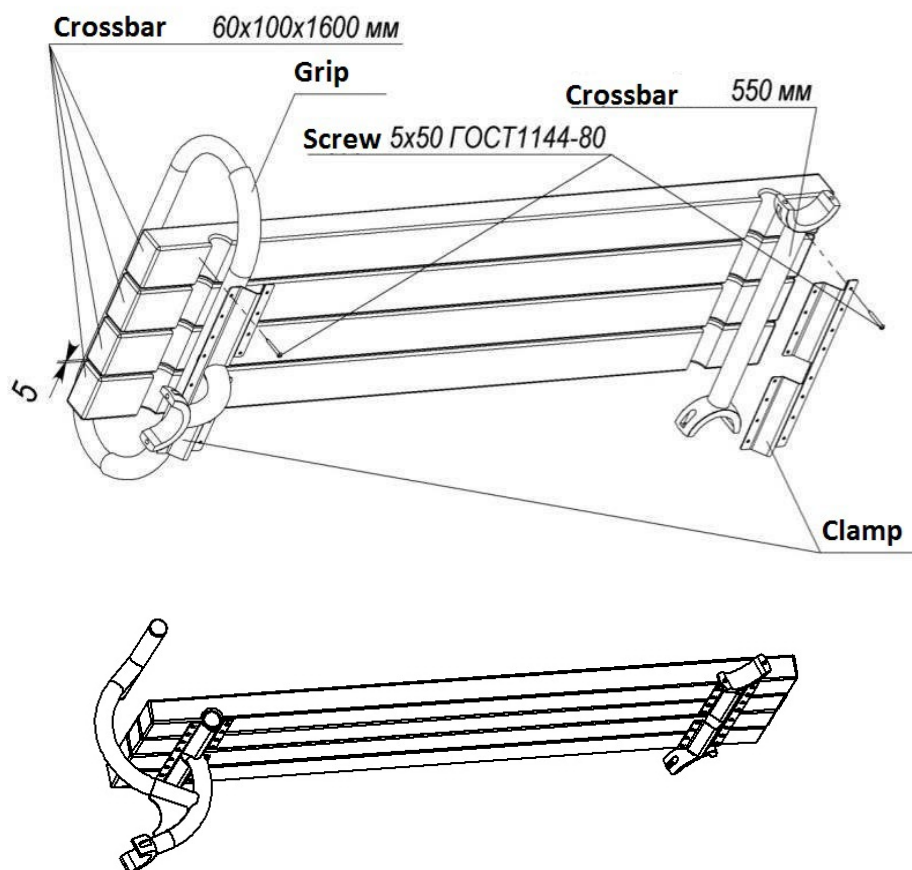

3. Install the hinged elements according to the drawing/appendix, depending on the type of clamp.

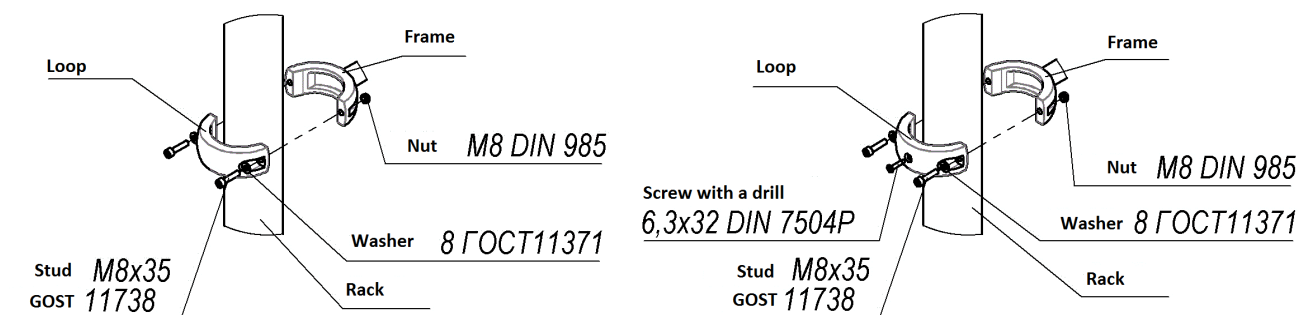

4. Install the product according to the level and pour concrete (concrete class not lower than B15), according to the concreting scheme. In the case of installation on sandy soil, the dimensions of the foundation must be increased by 15-20%.

The scheme of concreting the racks

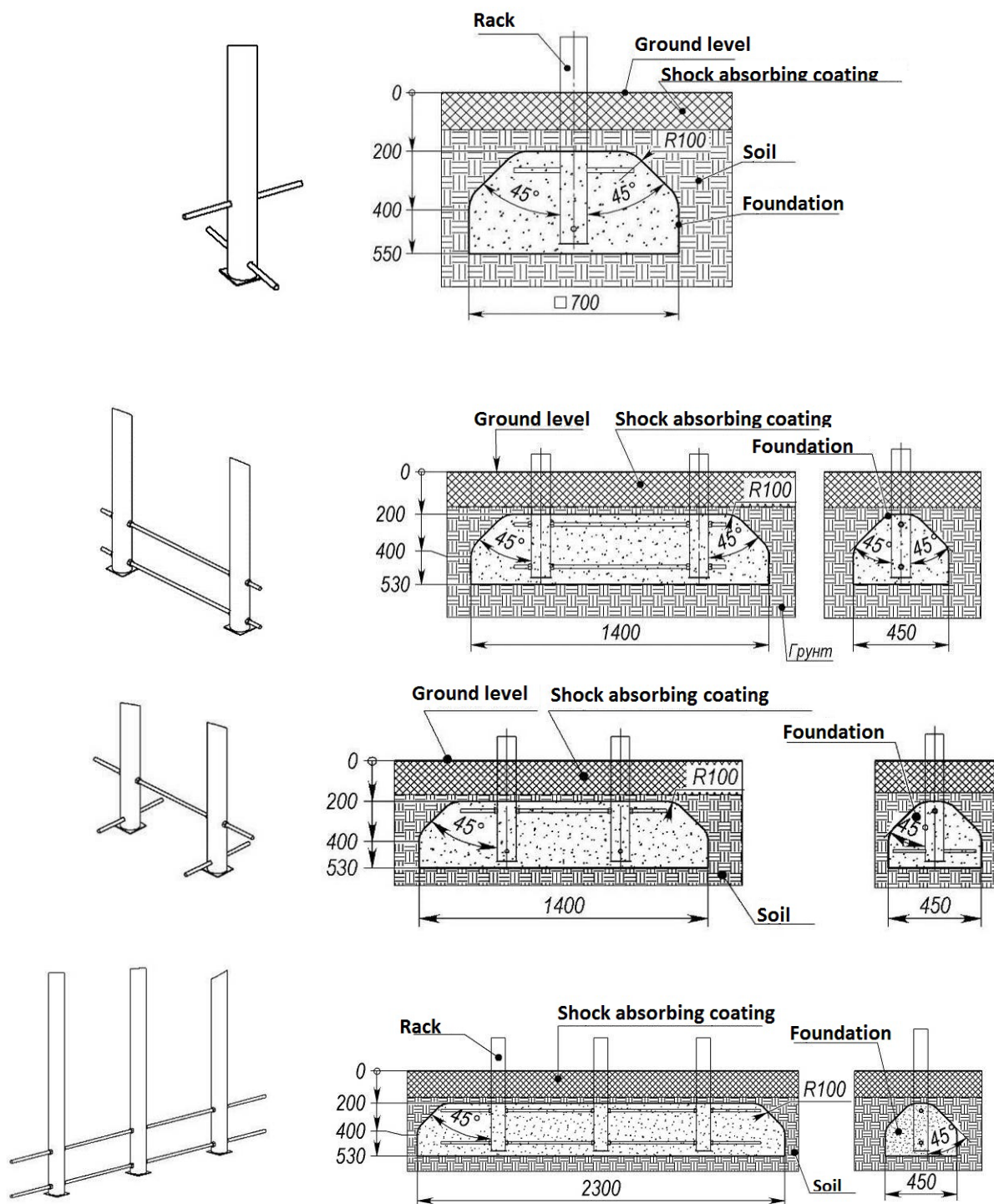

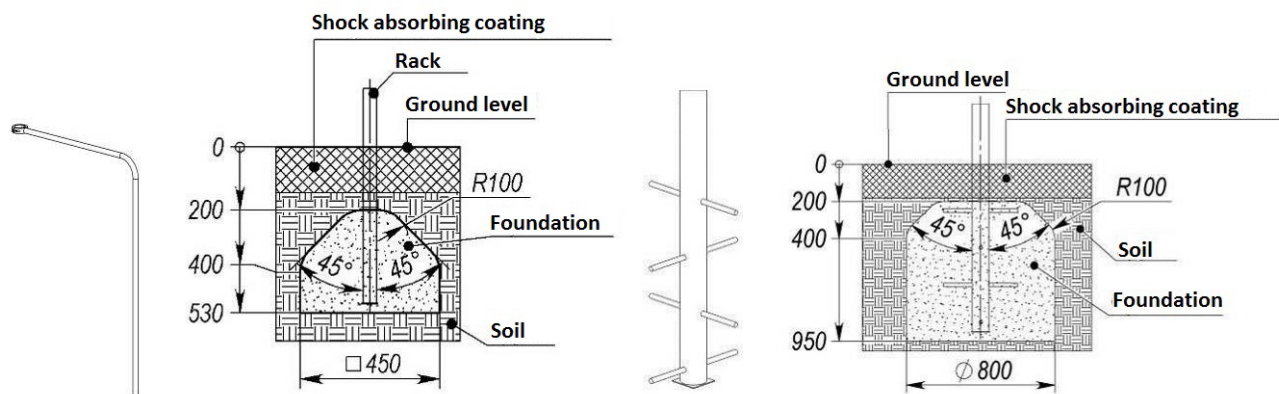

For racks of component elements

The stand is double

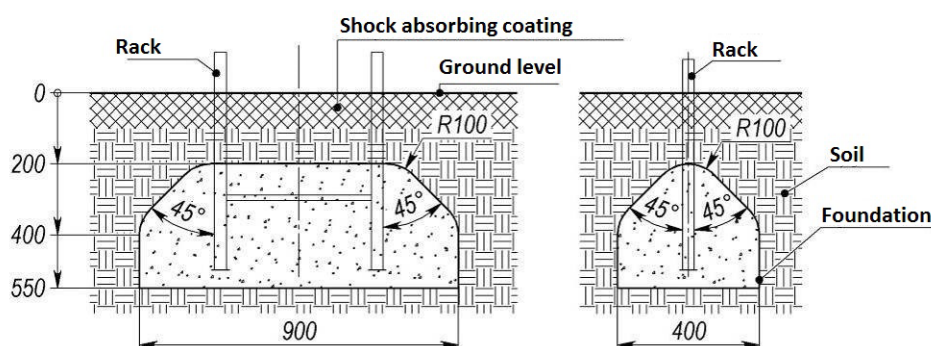

An example of a shock-absorbing coating

Nº	The material is a coating ¹	Description	Minimum layer thickness ¹ , mm	Max. drop height, mm
1	Concrete/stone	—	—	≤1 000
2	Surface bound with bitumen	—	—	≤1 000
3	Natural soil	—	—	≤1 200
4	Lawn	—	—	≤1 500
5	Wooden mulch	Shredded bark of coniferous trees, particle size from 20 to 80 mm	200	≤2 000
			300	≤3 000
6	Sawdust	Mechanically chipped wood (not wood materials), without bark or leaves, with a particle size of 5 to 30 mm	200	≤2 000
			300	≤3 000
7	Sand ^{2, 3} ,	Particle sizes from 0.2 to 2 mm	200	≤2 000
			300	≤3 000
8	Gravel ^{2, 3}	Particle sizes from 2 to 8 mm	200	≤2 000
			300	≤3 000
9	Other materials and layer thicknesses	Tested at HIC acc. EN 1177		Critical drop height according to test results

¹ For cushioning of bulk material, add 100 mm to the minimum layer thickness.

² There should not be any silty or clay fractions; particle size can be determined by sieve analysis according to EN 933-1.

³ Not suitable for simulators where a firm, stable position of the user is required.

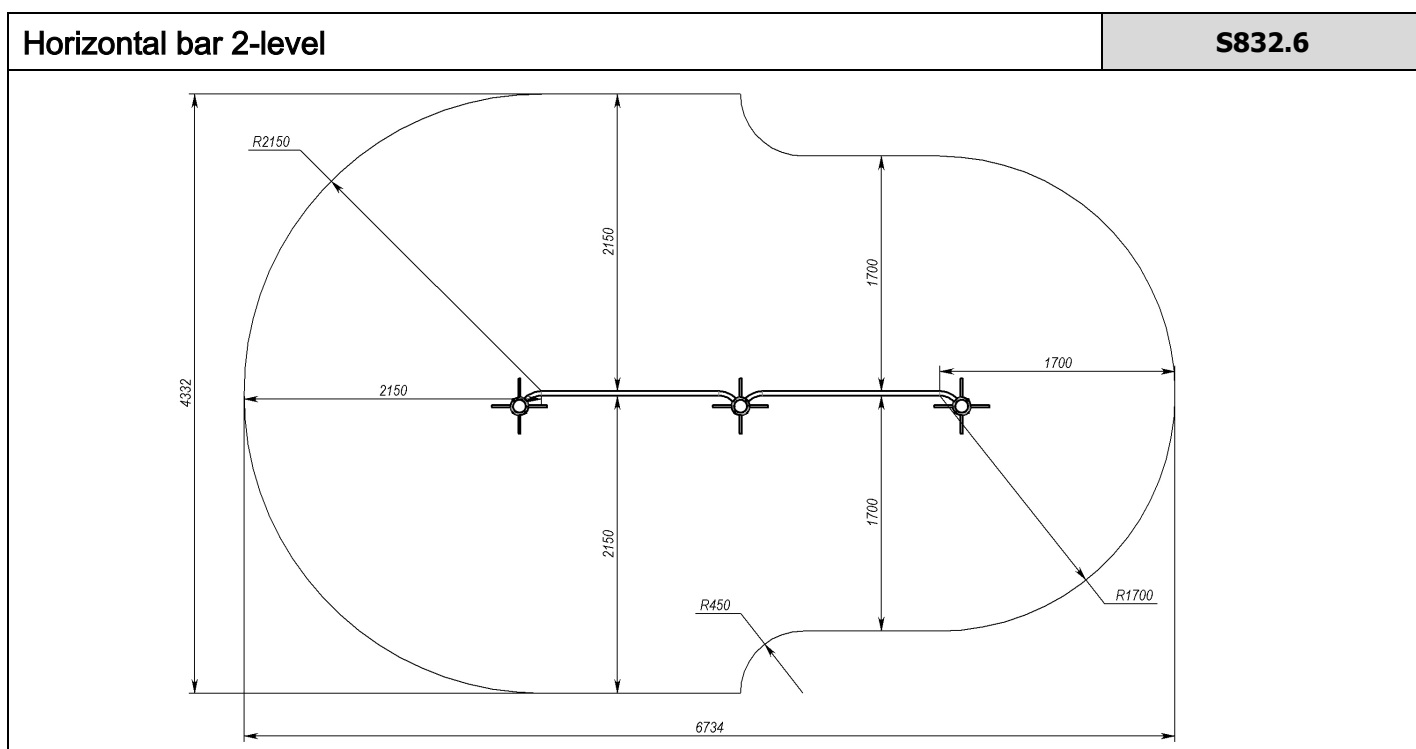

6. INFORMATION ON STORAGE, TRANSPORT AND DISPOSAL

The product is transported in the manufacturer's packaging by any type of transport, which ensures its preservation and protection from the influence of external factors (rain, snow, sunlight, water, high humidity, etc.).

Transportation information

Date		Brand, state vehicle/trailer number	Position, full name	Signature
Sending	Arrival			

Before installation, store the product in the factory packaging in dry, closed rooms with natural air ventilation.

If it is necessary to transport the product to another place after its use, it is recommended to use the manufacturer's packaging.

If long-term storage of the product is required, the following storage rules must be observed (the list of conditions is not complete):

- place the product in a closed, dry room with natural ventilation;
- protect the product from external factors (dust, water drops, etc.) with a large plastic bag, leaving space for free air circulation;
- take other measures to preserve the appearance and properties of the product during storage.

When removing the product from storage and preparing for installation, follow these recommendations:

- free the product from the packaging material (polyethylene, cardboard, other packaging materials);
- remove dust and other contamination from the surface of the product;
- check the completeness and absence of damage to parts.

Storage information

Date		Product storage conditions	Full name	Signature
Storage	Removal from storage			

After the end of the life of the equipment, the buyer independently determines the order of its use. If you decide to dispose of it, contact the seller or specialized organizations.

The equipment does not contain harmful impurities and materials that can harm your health and is not subject to special disposal.

Disposal of the product (remelting, burial, resale) in accordance with the procedure established by the Laws of Ukraine of 1992 No. 50, Art. 678, (as amended No. 2556 – III (2556-14) dated 21.06.2001, No. 48, Article 252 "On Protection of Atmospheric Air" (as amended from 14.07.2016); dated 1998 No. 36- 37, Article 242 "On Waste" (as amended from 04.09.2015); from 1991 No. 41, Article 546 "On Environmental Protection" (as amended from 04.10.2016), as well as other regulations, acts, rules, regulations, etc.

7. USE OF THE PRODUCT

It is forbidden to use the product until the work on its complete and final installation is completed.

The use of the product by users of a different age category is prohibited.

It is prohibited to use the product by users of another weight category.

Before using the product, it is necessary to clear the safety zone from unnecessary objects that may harm the user (garbage, tools left after assembly and installation, etc.).

It is forbidden to use the product in adverse weather conditions (icy, snowfall, rain, hail, strong wind, etc.), in which there is a possibility of injury to the user.

8. PRODUCT MAINTENANCE

You have purchased quality and reliable equipment. In the process of its production, the requirements of regulatory and technical documents of Ukraine, the CIS countries and the European Union, which regulate the production of children's play equipment, were taken into account. However, it should not be forgotten that certain rules and requirements must be observed when operating any technical product. Despite the fact that our product is of high quality and reliability, this rule applies to it in its entirety. You should be aware that the following rules and recommendations for product maintenance are aimed at ensuring that your child, the child of your friends or acquaintances is safe and that no unforeseen factors threaten their health or life.

Remember that the operation of the product is accompanied by the impact on it of various negative factors, the full list of which is impossible to predict. Among them, natural factors and factors caused by human influence on equipment occupy an important place. Usually, at first their action leads to violations of the appearance of the product. Thus, under the influence of factors caused by human exploitation, damage to the integrity of the paint coating of parts made of wood can occur in the form of burrs, chips, cuts, and when parts made of metal are affected, damage to the paint coating in the form of dents, chips, abrasions may occur etc. This leads to the appearance and development of defects, which can be the cause of the destruction of the product. Cases of using the product not for its intended purpose, exceeding permissible loads and acts of vandalism represent a special danger, because under the influence of these factors, irreversible changes may occur in the structure of the material from which the product is made, leading to destruction.

Maintenance of the product involves, first of all, the responsibility of the user to comply with all the recommendations provided for in this document, starting with a daily inspection of the external condition of the product before starting operation.

Daily inspection of the product is a very important procedure. With its help, you will be able to detect any changes in the appearance of the product in a timely manner (deformation of individual parts, deformation of the structure in general or its part, damage to parts, cracks in welding seams, as well as lack of fastening of product parts, etc.).

Before using the product, check its functionality, the absence of damage, dirt on the product, sharp edges, the reliability of fixing the structure, the absence of extra objects on the surface of the platform. In the presence of product breakdowns, its complete or partial inoperability and other identified defects, use is prohibited.

In the process of operation, it is also necessary to periodically inspect the condition of the product - a current inspection. It includes an external inspection of the product, checking its operability (in the presence of moving elements - smooth movement of mechanisms, compliance with operating modes, etc.). The current inspection allows you to detect malfunctions caused by equipment operation, climatic conditions, acts of vandalism and other factors, before they reach a critical value and destroy the product. The current inspection is carried out in order to identify foreign objects that may endanger the user and lead to malfunctions of the product. The periodicity of the current inspection is established by the owner, taking into account the operating conditions. If you do not have sufficient technical knowledge and skills to carry out such inspections, we recommend that you contact the authorized specialists of the manufacturing company for advice.

Every three months, a planned inspection should be carried out, which primarily concerns the foundation part, load-bearing elements and elements' connection nodes (their integrity and degree of wear).

The main annual inspection by authorized specialists of the manufacturing company must be carried out annually. During the inspection, the compliance of the technical condition of the equipment with safety requirements is evaluated. The degree of wear and damage of wooden elements and their ability to withstand applied loads, damage, the presence of corrosion of metal elements and the influence of the specified factors on the safety of product operation are determined. Also, the inspection makes it possible to identify the impact of the repair work, if any, on the safety of the equipment.

According to the results of the inspection, a maintenance procedure is carried out, designed to eliminate the identified inconsistencies in the operation of the product. This procedure includes assessing the condition of parts and assemblies, replacing worn parts, and restoring the integrity of protective coatings. The results of the performed inspections, as well as the procedures carried out based on the results of the inspection and maintenance of the product must be properly documented in the Registration Journal, which is an integral part of this passport. The owner of the product must keep acts of performance of work on technical maintenance of the product, acts of repair work.

Appendix A

S832.6 – Horizontal bar 2-level

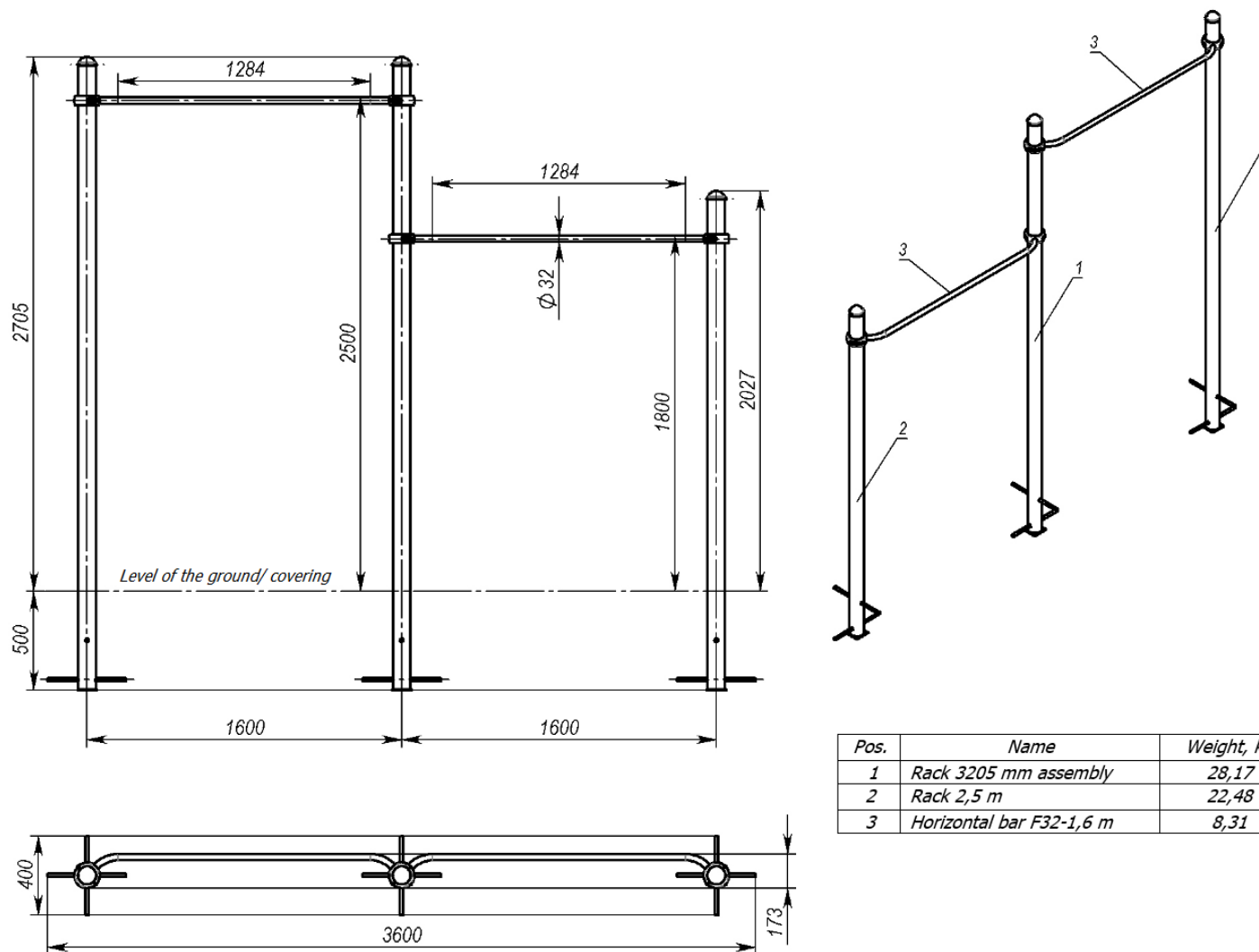

Pos.	Name	Weight, kg	Q-ty
1	Rack 3205 mm assembly	28,17	2
2	Rack 2,5 m	22,48	1
3	Horizontal bar F32-1,6 m	8,31	2